

REGIONAL PUBLIC SAFETY COMPLEX

2022

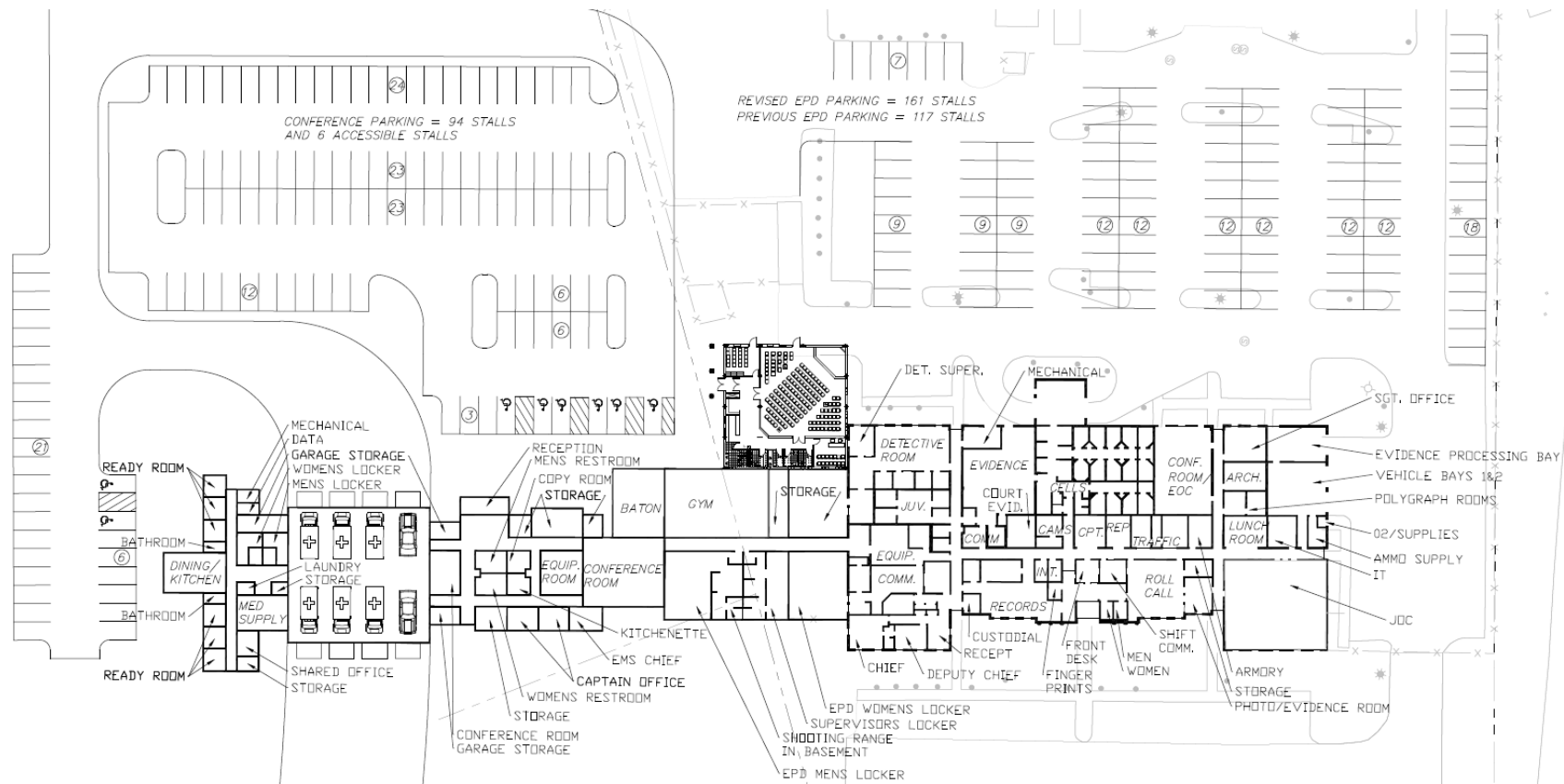



EXPANSION OF TOWN REAL ESTATE

Town Acquired Additional Property

- The Corner of Elm and Moody

Total Real Property

- 36 Acres Between Acquisition, DPW, and EPD

Critical Town Services

- Ample Room for Expansion
- EMS Outgrown Enfield Street Location
- PD Undersized to Support Modern Activities
- Exploration of Regionalization
- Linkage to Senior Center parking area

EMS GROWTH

Regional Public Safety Complex Solutions

- Modern Facilities With Needed Support Spaces to meet rigorous state regulations
- More Apparatus Bays to meet state regulations of all apparatus inside
- Safer Emergency Vehicle Road Access
- Temperature Controlled Medication Storage Room per state regulations

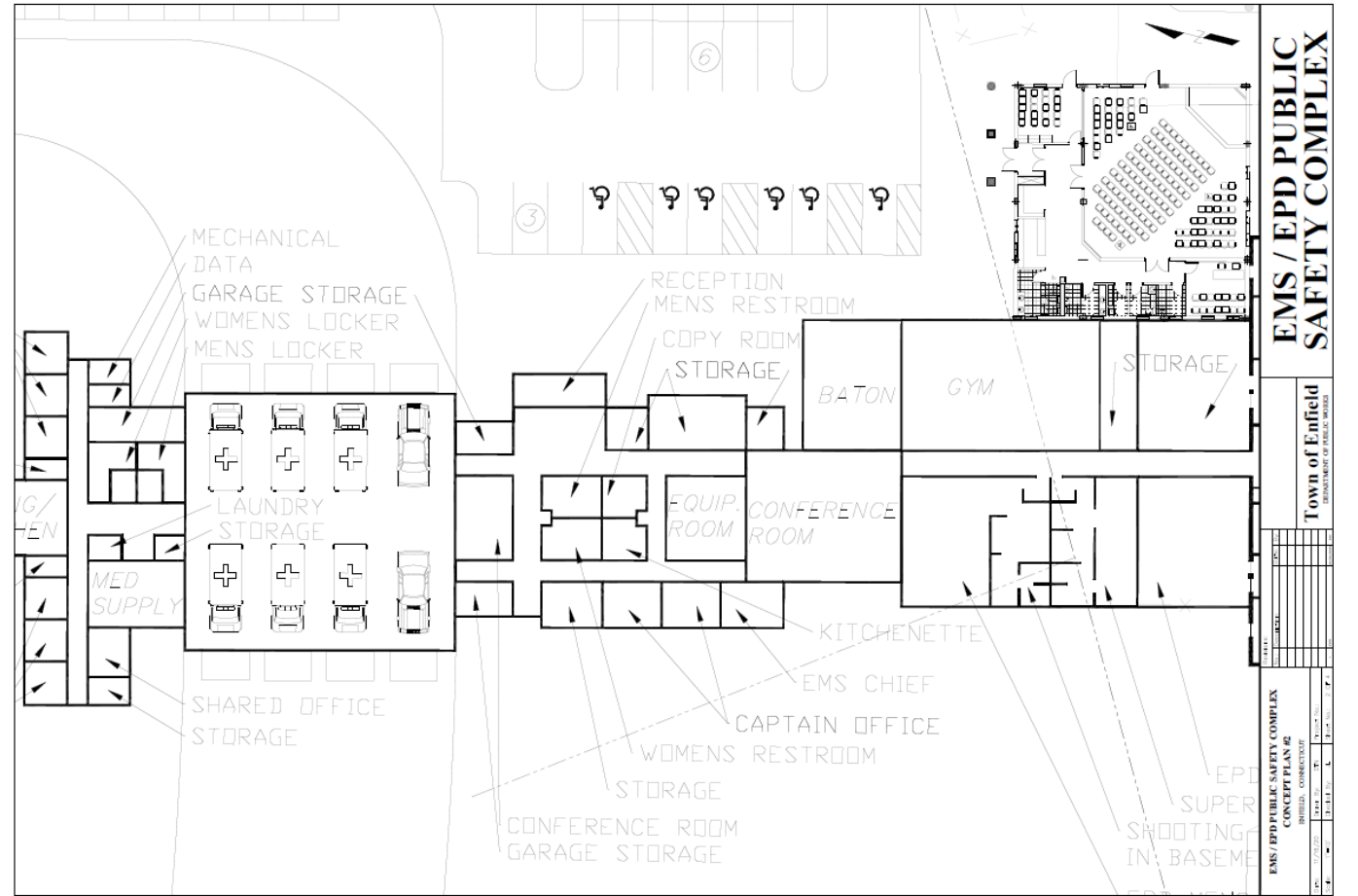

REGIONAL TRAINING CAPACITY

Business Style Auditorium and Conference Rooms

- EMS and PD are highly trained
 - Revenue for Town
 - Regional Training for Public Safety
- Distinguishing Enfield
 - Proactive Regional Approach
 - Positioning for Future Stability and Growth

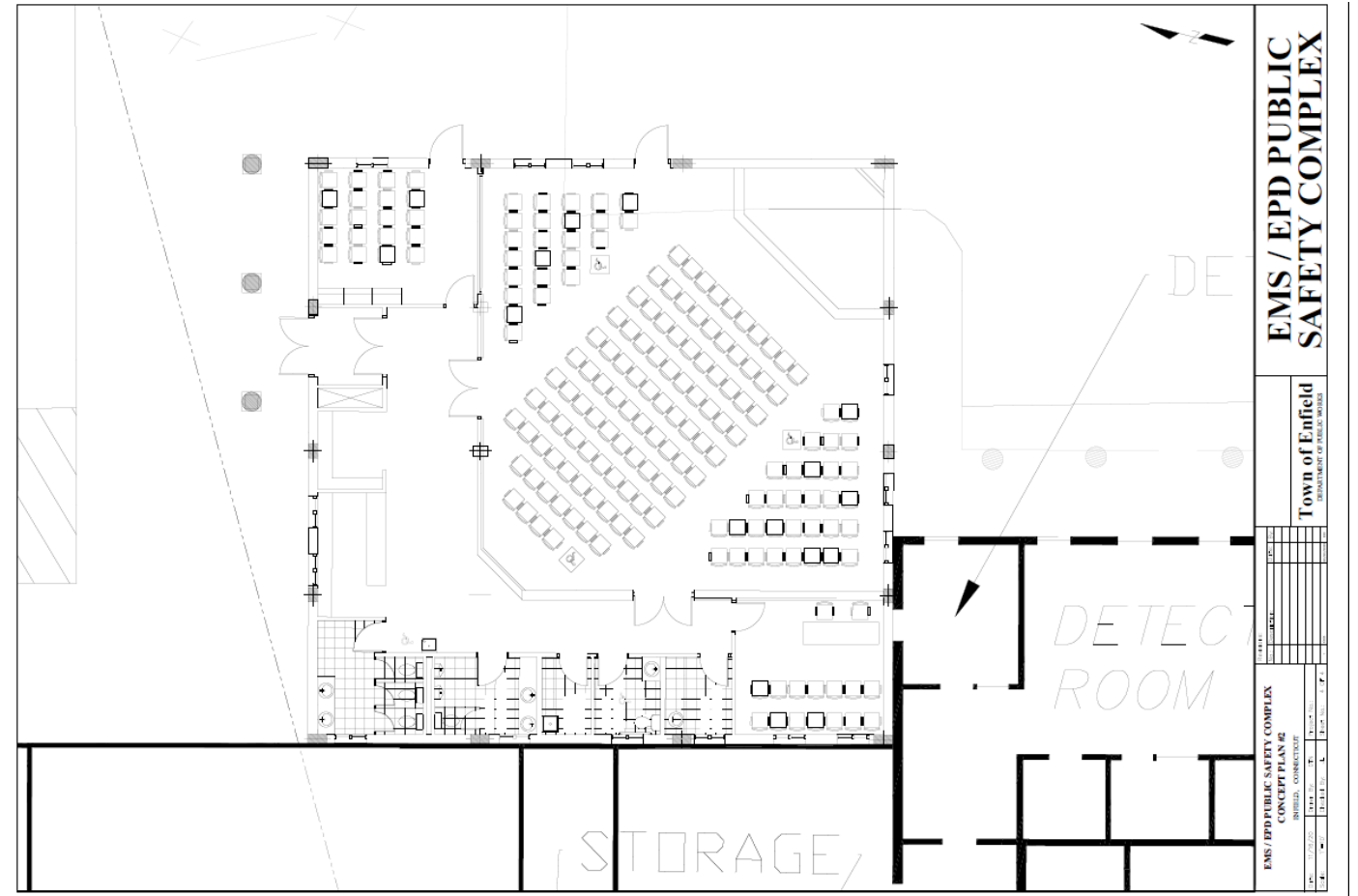

EPD Modernization

Regional Public Safety Complex Solutions

- Generates Money for Training Outside Agencies & Reduces Town Expenses
- Shooting Range improvements
- Increasing Space for Officers, Social Workers, DCF workers, and Support Staff as outlined in Police Accountability law.
- Improves conditions in Evidence and Technology areas, none of which were concerns when built

